

NOTES:

1. ALL DIMENSIONS IN MM [INCH]
2. GENERAL TOLERANCE: X.X=±0.4  
X.XX=±0.25
3. TERM. NOS. FOR REF. ONLY
4. RATING: 0.4VA MAX @20V MAX, AC OR DC
5. MATERIAL: FIXED TERMINAL & MOVING CONTACT  
Copper Alloy w/Gold Plate over Nickel Plate
6. CONTACT RESISTANCE: 10mOhms max initial  
@2-4VDC, 100mA for AG & AU
7. ELECTRICAL LIFE: 40,000 make-and-break  
cycles at full load.
8. INSULATION RESISTANCE: 1,000Mohm min.
9. DIELECTRIC STRENGTH: 1000V RMS @sed level
10. OPERATING TEMP.: -30°C to +85°C
11. 2002/95/EC (ROHS) COMPLIANT

RECOMMENDED P.C.B. LAYOUT

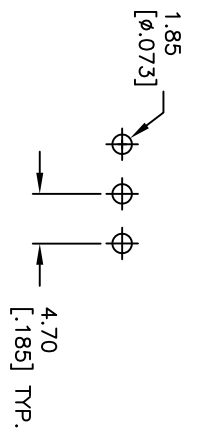

CIRCUIT: SPST

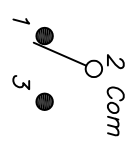

SWITCH FUNCTION

POS. 1	POS. 2	POS. 3
DN	NONE	DN
2-3	DPEN	2-1



300SPIRIRDM7RE

REV.	ECN NO.	DESCRIPTION	DATE	CHKD
A	21072	RELEASED FOR PRODUCTION	3/20/13	EBP

TITLE	SCALE	DATE	DR	DWG	REV
300SPIRIRDM7RE	2:1	3/20/13	EBP	T311096	A

THE INFORMATION CONTAINED IN THIS DOCUMENT IS PROPRIETARY TO E-SWITCH AND IS NOT TO BE COPIED OR TRANSMITTED